

NOTE:  
ELEVATION ARE SHOWN IN NAVD  
CONVERSION NAVD+1.58 = NGVD

Call 48 hours  
before you dig

It's the Law!  
1-800-432-4770

Sunshine State One Call of Florida, Inc.

NOTE:  
\* PRB REQUIRED THIS INVERT  
(PLEASE SEE PRB DETAIL)

- LEGEND**
- EX. PROPERTY/ROW LINE
  - PROPOSED DRAINAGE PIPE
  - PROPOSED YARD DRAIN
  - EXISTING GRADE
  - PROPOSED GRADE
  - MATCH EXISTING GRADE
  - PROPOSED WATER LINE
  - EXISTING WATER LINE
  - PROPOSED SANITARY SEWER LINE
  - EXISTING SANITARY SEWER LINE
  - PROPOSED ELECTRIC LINE
  - EXISTING OVERHEAD LINE
  - PROPOSED TELEPHONE/CABLE LINE
  - EXISTING TELEPHONE/CABLE LINE
  - PROPOSED GAS LINE
  - EXISTING GAS LINE
  - EXISTING FORCE MAIN
  - TO REMAIN
  - PROP. LIGHT POLES (SEE ARCH. PLANS FOR DETAILS)
  - PROP. BOLLARDS (SEE ARCH. PLANS FOR DETAILS)
- PROPOSED BUILDING
- PROPOSED PAVEMENT
- PROPOSED CONCRETE

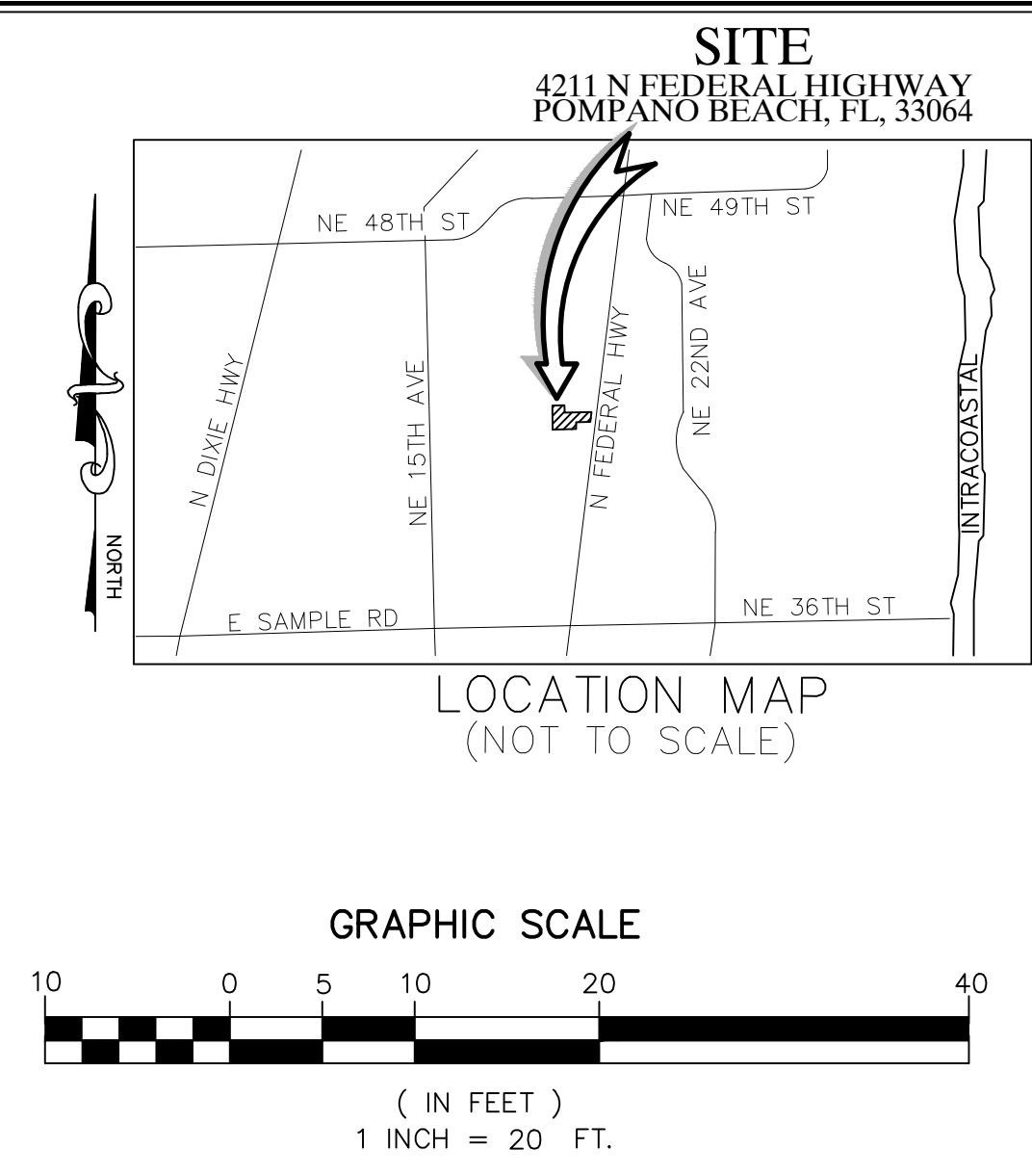

REV	PER CITY COMMENTS	DATE
01/28/26	DJP	
12/16/25	DJP	
10/27/25	DJP	
08/25/25	DJP	
08/25/25	REVISIONS	
DATE	BY	

CAULFIELD & WHEELER, INC.  
CIVIL ENGINEERING  
LANDSCAPE ARCHITECTURE - SURVEYING  
7900 GLADES ROAD - SUITE 100  
BOCA RATON, FLORIDA 33434  
PHONE (561) 392-1991 / FAX (561) 750-4452  
FILE NAME: 11146ENG.dwg

**THE SATORI**  
**4211 N FEDERAL HIGHWAY**  
**PROPOSED PAVING**  
**& GRADING PLAN**  
**POMPANO BEACH, FL, 33064**

DATE 05/28/25  
DRAWN BY DJP  
F.B./ PG. ---  
SCALE 1" = 20'

MATTHEW V. KAHN  
PROFESSIONAL ENGINEER  
LICENSE NO. 82227  
STATE OF FLORIDA  
- FOR THE FIRM -  
DATE

JOB # 11146  
SHT. NO.  
**PD-2**  
OF 16 SHEETS